

SA Power Mini Installation

Place the Actulux SA Power Mini opening system in center of the skylight.

- 1) The main part with the actuator and arm system is lowered into the skylight body frame, and fixed by 3 screws in each end. The white plastic LIP box should be opposite to the hinges.
- 2) The upper frame is mounted with 4 screws in each side. The U-rails must be 0-10 mm above the top of the lower skylight body frame.
- 3) All adjustments from 70-110cm is possible. When installed no further mechanical or electronic adjustments are necessary.
- 4) The actuator can be test operated up and down by connecting a 18-48V battery on the test wires.

Electrical Connection Information

- 5) The opening system **must always** be connected to 24 or 48VDC from the control panel. Connect through terminal 1&2 on the overload interrupter (LIP) that is fitted in series with the actuator, as the actuator has no limit switches.

The actuator will be destroyed if the overload interrupter (LIP) is not installed in series with the actuator. The test cable is not fireproof. Do not use for permanent connection.

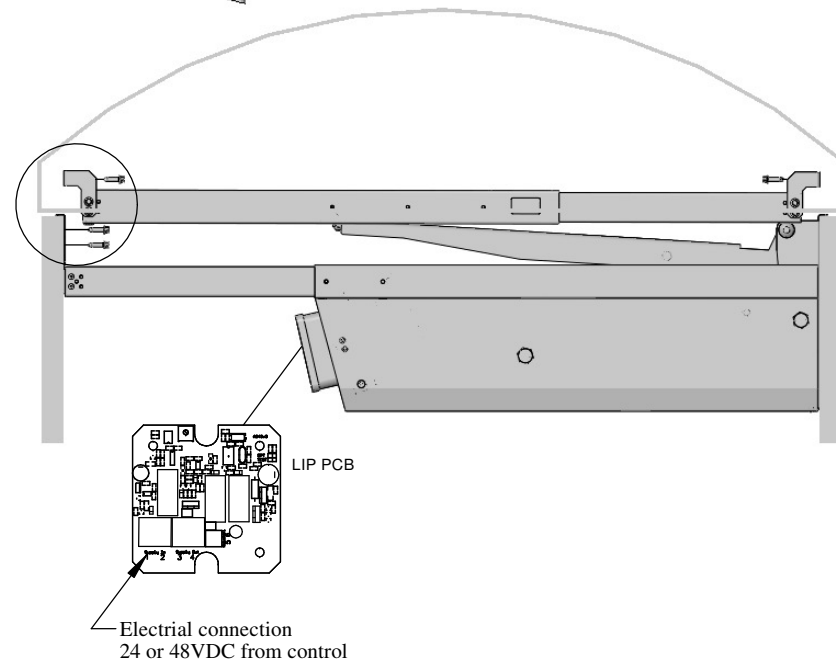
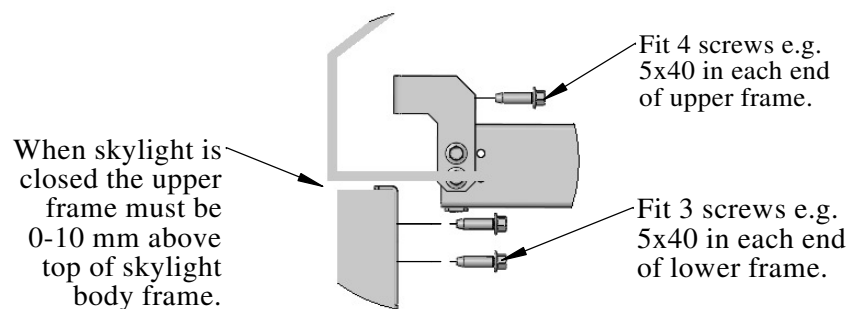

To connect the upper and the main part turn the upper part and attach the black wheels in the U-frame and fit the screws in the opening frame.

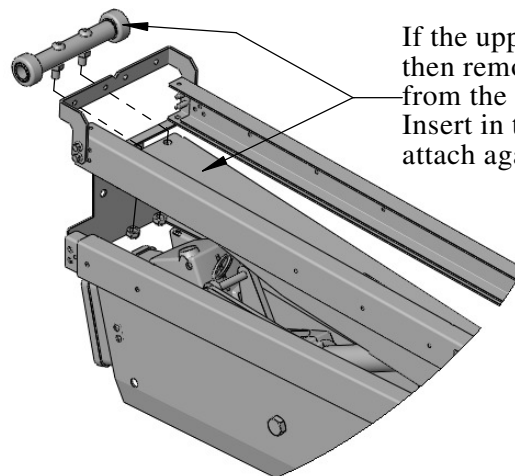
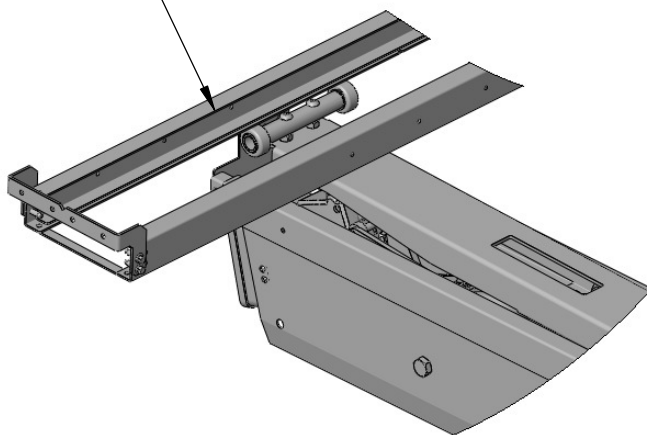

Actulux

Actulux A/S
2. Haandvaerkervej
DK 9560 Hadsund
Denmark

Phone int.: +45 98 57 40 90
Fax int.: +45 96 15 28 00
e-mail: info@actulux.com
www.actulux.com

154221